

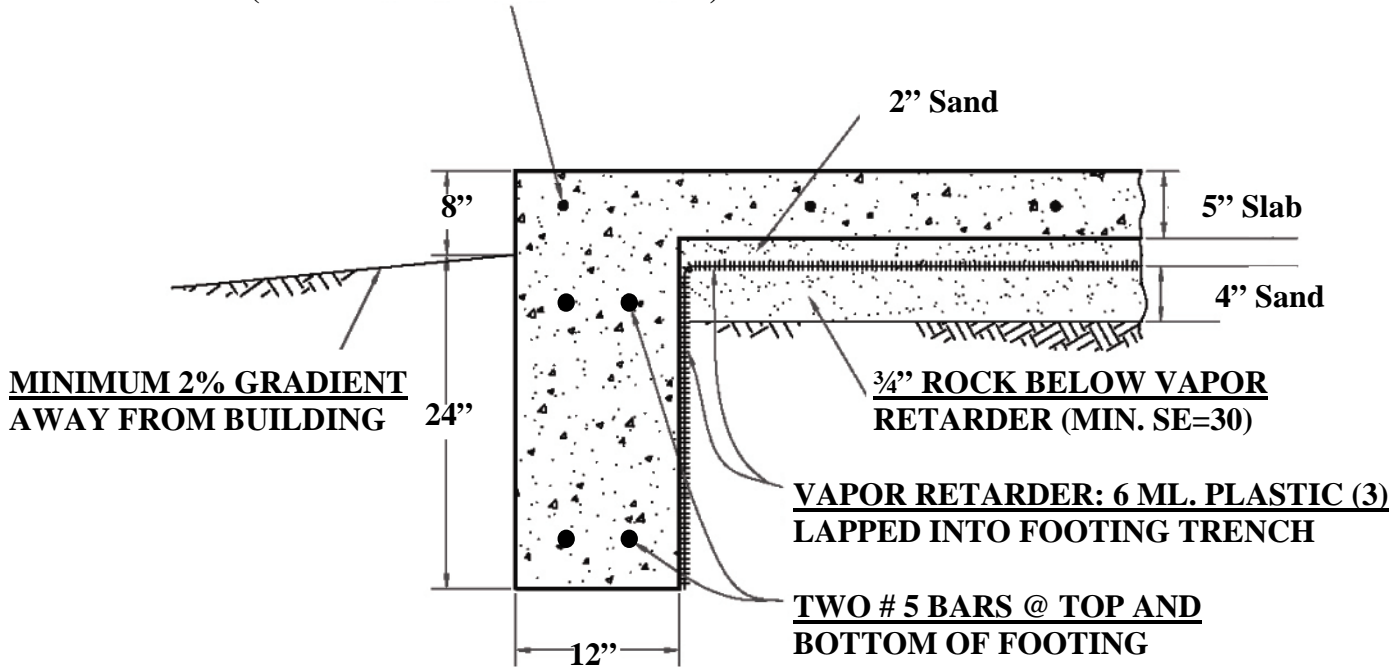

**SLAB REINFORCEMENT: #4 BARS @ 18" ON CENTER, EACH WAY**  
**(PLACED IN SLAB MID POINT)**



Notes:

- **CONCRETE IN CONTACT WITH THE SOIL SHALL HAVE AN ULTIMATE COMPRESSIVE STRENGTH OF 4,500 P.S.I., WATER-CEMENT RATIO OF 0.45 AND TYPE V CEMENT UNLESS SOIL REPORT RECOMMENDS OTHERWISE**
- **SUBGRADE TO BE FIRM AND MOIST**
- **FOR ADDITIONAL MOISTURE / VAPOR PROTECTION THE USE OF A RETARDER WITH A MAXIMUM PERMEANCE OF 0.04 PERMS SHOULD BE CONSIDERED**
- **SPECIAL RECOMMENDATIONS FROM A STRUCTURAL ENGINEER WILL BE REQUIRED IF THE EXISTING SLAB IS A POST TENSION SLAB.**

**MINIMUM REQUIREMENTS  
WHEN NO SOILS REPORT IS  
PROVIDED FOR ALL NEW  
CONSTRUCTION/ADDITIONS.**