



**City of Laguna Niguel**  
**Building Division**  
30111 Crown Valley Pkwy  
Laguna Niguel, CA 92677  
(949) 362-4360  
www.CityofLagunaNiguel.org

# **SMOKE & CARBON MONOXIDE DETECTOR REQUIREMENTS**

# **130**

## **Smoke & Carbon Monoxide detector verification requirements for all residential construction projects;**

Please be advised that the 2016 California Building Code (CBC), and California Residential Code (CRC), requires smoke & carbon monoxide detectors to be installed in prescribed locations as part of any alteration, repair or addition requiring a permit.

Smoke & carbon monoxide detectors are required to be located as follows and if retrofitted may be battery operated with a sealed unit containing a 10 year life battery: in the following locations:

- Smoke & carbon monoxide detectors are required on the ceiling or wall outside each separate sleeping area in the immediate vicinity of bedrooms.
- Smoke detectors in each room used for sleeping purposes.
- In each story within a dwelling unit, including basements but not including crawl spaces and uninhabitable attics. In dwellings or dwelling units with split-levels and without an intervening door between the adjacent levels, a smoke & carbon monoxide detectors are required to be installed on the upper level shall suffice for the adjacent lower level provided that the lower level is less than one full story below the upper level.

In lieu of physical verification by a City building inspector, this self-certification on Page 2 may be provided.

This certification may be signed by the owner, occupant, or contractor of the residence.



**City of Laguna Niguel**  
**Building Division**  
30111 Crown Valley Pkwy  
Laguna Niguel, CA 92677  
(949) 362-4360  
www.CityofLagunaNiguel.org

# **SMOKE & CARBON MONOXIDE DETECTOR REQUIREMENTS**

# **130**

## **SMOKE DETECTOR SELF CERTIFICATION**

Project Address: \_\_\_\_\_

Permit Number: \_\_\_\_\_

I am the property  owner  occupant  contractor

Print Name: \_\_\_\_\_

---

I, the undersigned, hereby certify that I am the owner, occupant, or contractor of the above referenced property. I further certify that smoke alarms and carbon monoxide alarms are present and functional in all the following locations (Note: All boxes below must be initiated; retrofitted co/smoke detectors may be battery operated. New Co/smoke detectors shall have a 10 year life battery in a sealed unit.)

- Smoke Alarms and Carbon Monoxide Alarm: On the ceiling or wall outside of each separate sleeping area in the immediate vicinity of bedrooms or in each hallway outside of the rooms.
- Smoke Alarms: In each room used for sleeping purposes.
- Smoke Alarms and Carbon Monoxide Alarm: In each story, including any habitable basement. (Note: In dwellings or dwelling units with split levels and without an intervening door between the adjacent levels, a smoke alarm and a carbon monoxide detector installed on the upper level shall suffice for the adjacent lower level provided that the lower level is less than one full story below the upper level.)

Signature \_\_\_\_\_ Date: \_\_\_\_\_

---

**California Residential Code (CRC) Section R314.1, CRC R315.2 states in part that existing dwellings be "...retrofitted with smoke detectors and carbon monoxide detectors that are a sealed units with a 10 year life battery in a sealed unit, for any building permit issued. CRC Section R314.3, CRC R315.3 defines the required locations as indicated above.**

---

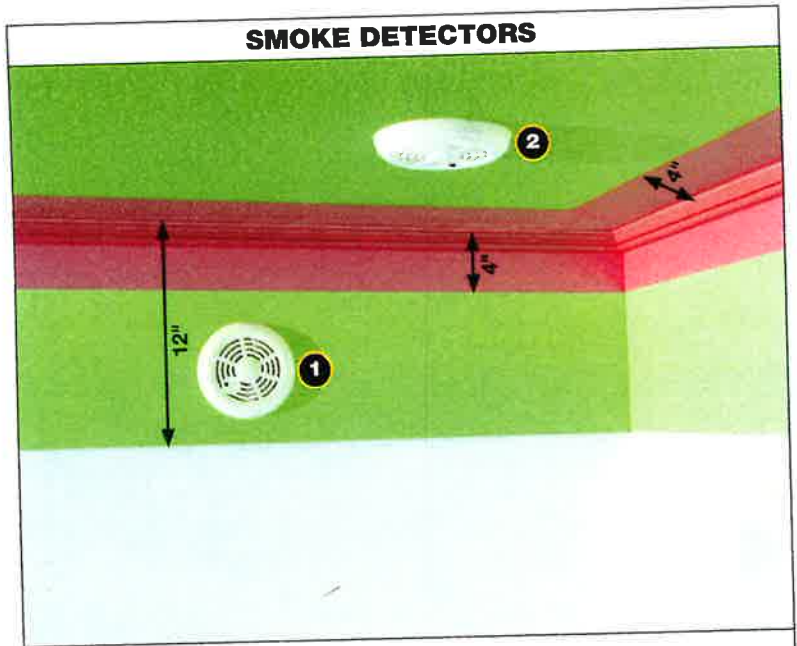

- Smoke detectors can be installed in this area
- Smoke detectors can NOT be installed in this area

No.	Code	Description
1	NFPA 72	Smoke detectors located on the wall must be located no closer than 4" from the ceiling and no further than 12" from the ceiling.
2	NFPA 72	Smoke detectors located on the ceiling must be located no closer than 4" from the wall.

**SMOKE DETECTOR PLACEMENT**  
**PEAKED CEILINGS**

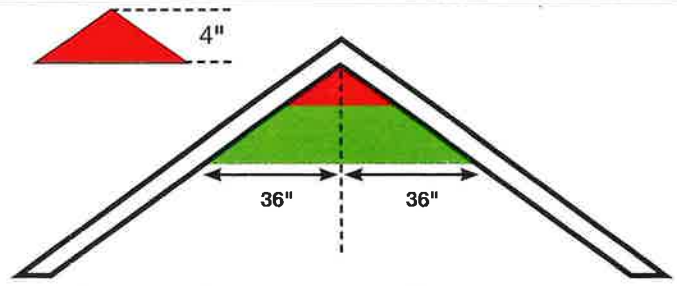

Smoke detectors must be located within 36" horizontally of the peak, but no closer than 4" vertically to the peak.

**TRAY CEILINGS**

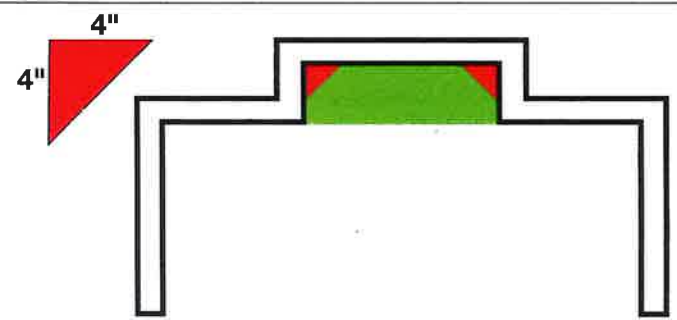

Smoke detectors must be installed on the highest point of the ceiling no closer than 4" from the sidewall or on the sidewall of the tray portion between 4" and 12" from the ceiling.

**SLOPED CEILINGS**

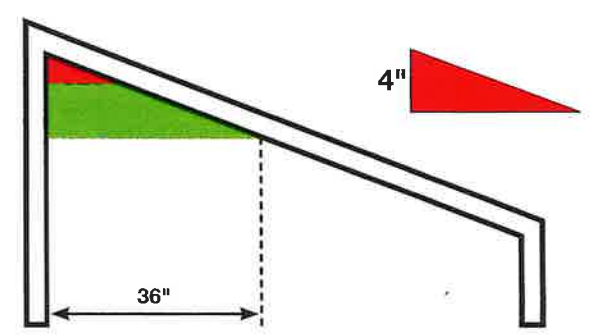

Smoke detectors must be installed within 36" of the high side of the ceiling, but not closer than 4" from the adjoining wall surface.

**YOU SHOULD KNOW:**

- **2014 NEC:** 110.3(B) Requires all manufacturers instructions to be followed when installing listed equipment such as smoke detectors.
- NFPA 72 mandates smoke detector placement. Manufacturer's instructions provide these rules for smoke detector placement. Read instructions carefully.